

ADAPTER NIPPEL

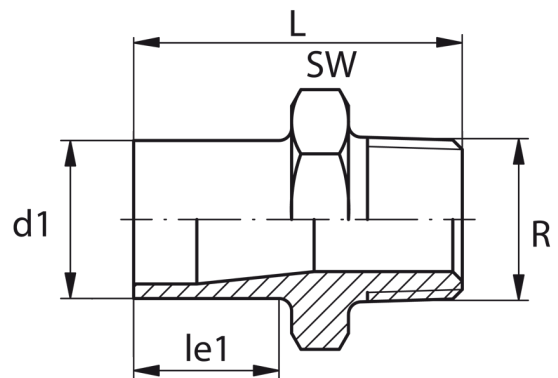

male thread
do not use thread sealing pastes that are harmful to PE
install with low mechanical stress and avoid large cyclic temperature changes

PE100



SDR 11



Art. No.	d1 [mm]	R [mm]	le1 [mm]	L [mm]	SW [mm]	kg
13302342	25	3/4"	23	52	36	0,03

For questions, please feel free to contact us at: Tel. + 49 281 98 414 - 0