

closed version extended with pipe

PE100-RC

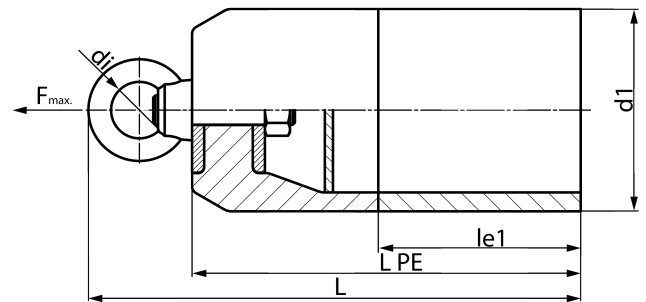

SDR 17

| Art. No. | d1 [mm] | le1 [mm] | le1* [mm] | L [mm] | kg |
|----------|------------|-------------|--------------|-----------|------|
| 36105201 | 200 | 150 | 150 | 464 | 9,63 |

The towing rope has to be attached to the pull head using a rotating shackle
 Special versions, e.g. for swagelining procedure on request
 other pulling forces on request

For questions, please feel free to contact us at: Tel. + 49 281 98 414 - 0