

TRANSITION COUPLER

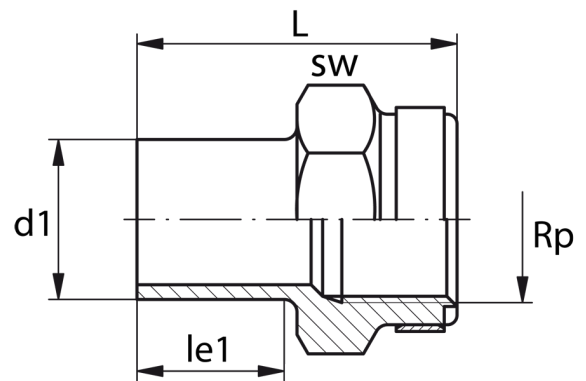

female thread
reinforcing ring stainless (V2A)
connection to plastic or metal threads
do not use thread sealing pastes that are harmful to PE
install with low mechanical stress and avoid large cyclic temperature changes

PP



SDR 11

Art. No.	d1 [mm]	Rp [mm]	le1 [mm]	L [mm]	SW [mm]	kg
23214041	40	1 1/4"	23	56	55	0,07

For questions, please feel free to contact us at: Tel. + 49 281 98 414 - 0