

# ADAPTER NIPPEL

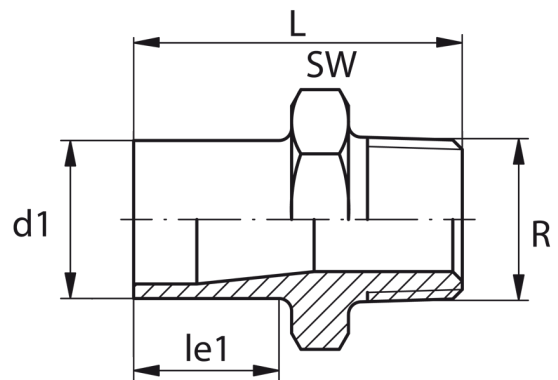

male thread  
do not use thread sealing pastes that are harmful to PE  
install with low mechanical stress and avoid large cyclic temperature changes

PP



## SDR 11

Art. No.	d1 [mm]	Rp [mm]	le1 [mm]	L [mm]	SW [mm]	kg
23302342	25	3/4"	23	52	36	0,03

For questions, please feel free to contact us at: Tel. + 49 281 98 414 - 0