

# ELECTROFUSION CONCRETE SHAFT ADAPTER

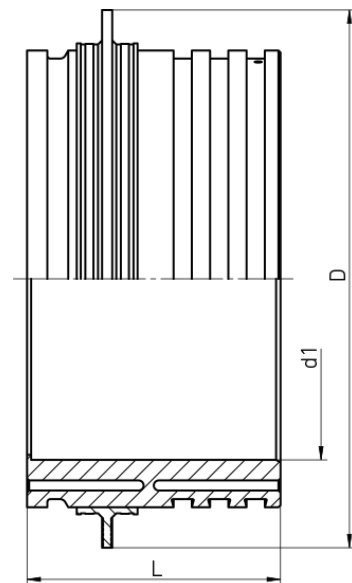

for permanently sealed manhole connections  
with integrated heating coils  
4,0 mm pin  
with angle movement  $\pm 3^\circ$  and pipe stop

PE100-RC



Art. No.	d1 [mm]	D [mm]	L [mm]	PFA [bar]	kg
36025280-EF	280	498	250	0,5	14,00

Other lengths on request  
Without angle compensation on request  
Without pipe stop on request

For questions, please feel free to contact us at: Tel. + 49 281 98 414 - 0