

# TRANSITION SADDLE FOR CONNECTION OF IRRIGATION SYSTEMS

outlet with female thread  
4 mm Pin  
Pressure ratings: Water 16 bar / Gas 10 bar

PE100

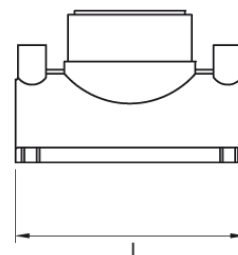
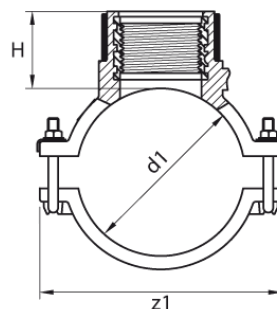

Art. No.	d1 [mm]	Rp [mm]	L [mm]	z1 [mm]	H [mm]	VE	kg
47611202	110	2"	166	180	56	2	2,18

For questions, please feel free to contact us at: Tel. + 49 281 98 414 - 0